

GENERAL

This installation and maintenance instruction sheet of the solenoid is a general supplement to the particular I&M sheet for the valve. The identification is made by prefix DU to the catalogue number. Always use both I&M sheets for installing and maintaining the solenoid valve.

DESCRIPTION

The solenoid valves are designed in accordance with Annex II of the European Directive 94/9/EC and CENELEC standards EN 13463-1, EN 50014 and EN 50281-1-1. Classification II 3D IP65.

INSTALLATION

ASCO/JOUCOMATIC components are intended to be used only within the technical characteristics as specified on the nameplate. Changes to the equipment are only allowed after consulting the manufacturer or its representative. These solenoid valves are intended for installation in potentially explosive atmospheres, Group II dusts (Group D, category 3). The surface temperature classification depends on wattage and ambient temperature and is stated on the nameplate. Depending on the ambient temperature/wattage, a heat resistant cable, suitable for temperature as indicated on the nameplate, must be used.

ELECTRICAL INSTALLATION

Wiring must comply with local and national regulations of explosion proof equipment. To make the electrical connection to the spade plug connector, strip the outer insulation of the cable back over approximately 30 mm and the insulation from the leads over 5 mm. Select the proper sealing ring Ø 6-8 mm or Ø 8-10 mm depending on cable diameter. Insert cable through the compression screw, washer, sealing ring and connector housing and connect wires to the terminal block. Place terminal block into connector housing and assemble connector cover. Note that the cover must be pressed properly to the connector until a 'click' is heard. The terminal block can be mounted in different positions to select the most favourable position for the cable entry. Assemble the sealing ring, washer and tighten the compression screw into the connector housing in such a manner that the seal fits tightly around the cable. Position connector gasket, place connector over coil spades and tighten the central screw to specified torque to ensure proper gaskets compression. The coil itself can be rotated 360° to select the most favourable position for the cable entry.
NOTE: THE STANDARD CABLE GLAND ACCEPTS CABLES WITH OVERALL O.D. from 6 to 10 mm.

CAUTION

Electrical load must be within the range stated on the nameplate. Failure to stay within the electrical range of the coil rating results in damage to or premature failure of the coil. It will also invalidate the approval.

SERVICE

To prevent the possibility of personal or property damage, do not touch the solenoid. It can become hot under normal operation conditions. If the solenoid valve is easily accessible, the installer must provide protection preventing accidental contact. Do not separate spadeplug connector when energized. To prevent electrostatic hazard, clean solenoid surface only with a damp cloth. Do not use solvents.

MAINTENANCE

Maintenance depends on service conditions. Periodic cleaning is recommended, the timing of which will depend on the media and service conditions. During servicing, components should be examined for excessive wear. A complete set of internal parts is available as a spare parts kit. If a problem occurs during installation/maintenance or in case of doubt please contact ASCO/JOUCOMATIC or authorized representative. CAUTION: Before servicing the solenoid valve, turn off electrical power, depressurize valve and vent fluid to a safe area. Solenoid must be fully reassembled as the housing and internal parts complete the magnetic circuit. In case of any replacement of parts by the user, the traceability of the final product can not be guaranteed by ASCO/JOUCOMATIC. Wrong assembly will invalidate the approval.

DECLARATION

For additional information visit our internet site: www.ascojoucomatic.com

ASCO®	DRAWING	DESSIN	ZEICHNUNG
	DISEGNO	TEKENING	

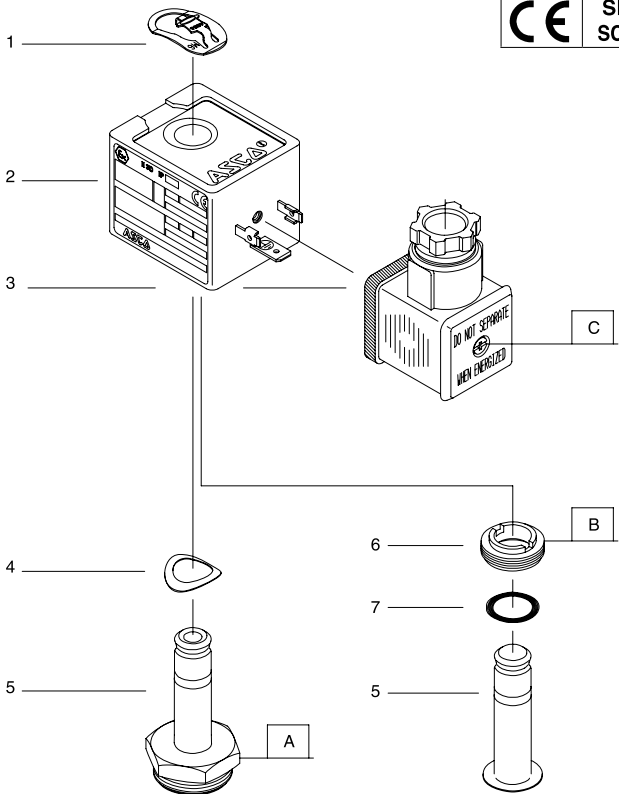
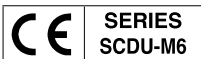

2/2 PULL TYPE - 15/16
TYPE EXTRACTION 2/2 - 15/16
2/2-ZUGAUSFÜHRUNG - 15/16
TIPO AD ESTRAZIONE 2/2 - 15/16
2/2 TREK - 15/16

2/2 PULL TYPE - 3/4
TYPE EXTRACTION 2/2 - 3/4
2/2-ZUGAUSFÜHRUNG - 3/4
TIPO AD ESTRAZIONE 2/2 - 3/4
2/2 TREK - 3/4

ASCO®	DRAWING	DESSIN	ZEICHNUNG
	DISEGNO	TEKENING	

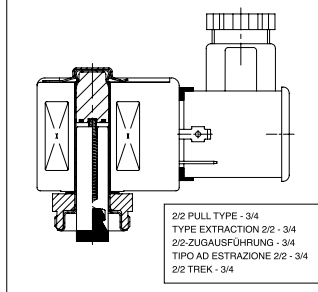
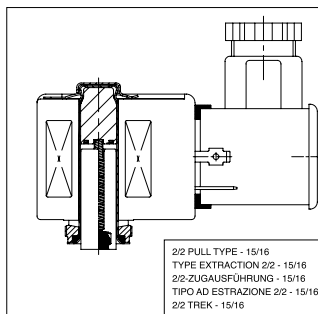

GB	DESCRIPTION
----	-------------

1. Clip, retaining
2. Coil
3. Connector assembly
4. Washer, spring
5. Sol. base sub-assembly
6. Bonnet
7. O-ring, bonnet

FR	DESCRIPTION
----	-------------

1. Clip de maintien
2. Bobine
3. Montage du connecteur
4. Rondelle élastique, ressort
5. Sous-ensemble de la base du sol.
6. Couvercle
7. Joint torique, couvercle

DE	BESCHREIBUNG
----	--------------

1. Klammerhalterung
2. Magnetspule
3. Gerätesteckdose
4. Federscheibe
5. Haltermutter
6. Ventildeckel
7. Dichtungsring, Ventildeckel

IT	DESCRIZIONE
----	-------------

1. Clip di fissaggio
2. Bobina
3. Gruppo connettore
4. Rondella, molla
5. Gruppo canotto solenoide
6. Coperchio
7. Anello di ritenuta, coperchio

NL	BESCHRIJVING
----	--------------

1. Bevestigingsclip
2. Spoel
3. Steker
4. Veerring
5. Kopstuk/deksel-combinatie
6. Klepdeksel
7. O-ring, klepdeksel

GB	* Supplied in spare part kit
FR	* Livrées en pochette de rechange
DE	* Enthalten im Ersatzteilsatz
IT	* Disponibile nel Kit parti di ricambio
NL	* Geleverd in vervangingsset

TORQUE CHART		
A	20±3	175±25
B	10±1	90±10
C	0,6±0,2	5±2
ITEMS	NEWTON.METRES	INCH.POUNDS